

## Specifications

### **Schwinn Series 34026; Schwinn Item 34026 Knob**

Design: Michael Graves



## **Application**

Drawer/Cabinet Knob

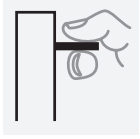

## **Characteristics**

Material: Steel/Leather

Finish: Plated

Weight: 20 g (0.71 oz)

Dimensions: 29 x 29 mm

C/C 0; M4 Thread

Care: Damp, non-abrasive cloth with mild soap only.

## **Finish Options**

Polished Chrome/Brown Leather - Order Nr. 60118

Polished Chrome/Natural Leather - Order Nr. 60116

Polished Chrome/Charcoal Leather - Order Nr. 60100

## **Environmental**

- Fully Recyclable

- Meets RoHS Standards

ADA Compliant: Yes

## **Warranty**

Limited lifetime.

## **Designer**

Michael Graves (1934-2015) started as a professor of architecture in 1962 at Princeton University and spent much of the late 1960s and early 1970s designing modern residences. In the late 1970s, Graves shifted away from modernism to pursue Postmodernism and New Urbanism. Postmodernism allowed Graves to introduce his humanist vision of classicism, as well as his sense of irony and humor. He also designed numerous household products for Target and other corporations. Most famous is his 1985-designed iconic stainless steel tea kettle featuring a red bird-shaped whistle at the end of the spout.

© Michael Graves, Schwinn under license.

