

## Specifications

### **Schwinn Series 2Z365; Schwinn Item 2Z365/16 Knob**

Design: Michael Graves



## **Application**

Drawer/Cabinet Knob

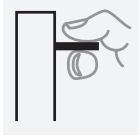

## **Characteristics**

Material: Zamak

Finish: Plated, Powder Coated

Weight: 20 g (0.71 oz)

Dimensions: 36 x 18 x 25 mm

C/C 16; M4 Thread

Provided Hardware: 7 mm Drill Bit, Short M4 Screws

Care: Damp, non-abrasive cloth with mild soap only.

## **Finish Options**

Polished Chrome - Order Nr. 60092

Matte Black - Order Nr. 60093

Matte Gold - Order Nr. 60094

## **Environmental**

- Fully Recyclable

- Meets RoHS Standards

ADA Compliant: No

## **Warranty**

Limited lifetime.

## **Designer**

Michael Graves (1934-2015) started as a professor of architecture in 1962 at Princeton University and spent much of the late 1960s and early 1970s designing modern residences. In the late 1970s, Graves shifted away from modernism to pursue Postmodernism and New Urbanism. Postmodernism allowed Graves to introduce his humanist vision of classicism, as well as his sense of irony and humor. He also designed numerous household products for Target and other corporations. Most famous is his 1985-designed iconic stainless steel tea kettle featuring a red bird-shaped whistle at the end of the spout.

© Michael Graves, Schwinn under license.

